

Welcome  
**START GUIDE**

***CELERO*5G**

Start Guide



***CELERO*5G**

## At a glance

Let's get started. We'll guide you through startup and tell you where to find more information about your phone and its great features.

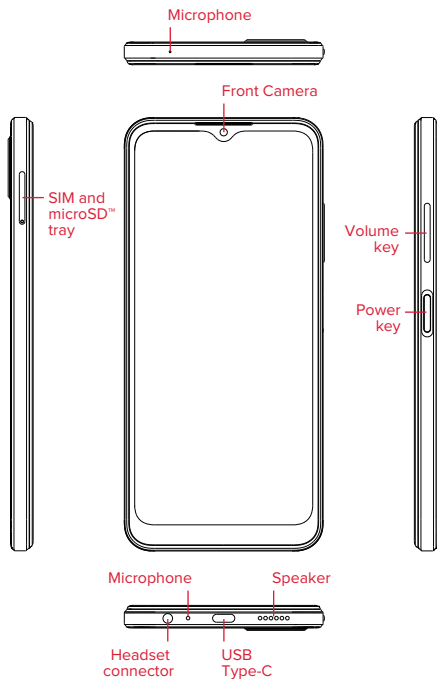

## Set up your SIM card

The SIM card identifies your device to the wireless network. You can't make or receive phone calls without a properly installed SIM card unless it's an emergency call (9-1-1).

You don't need to power off your device before inserting or removing the SIM card.

*Note: Your device only supports Nano SIM cards. To avoid damage to your device, do not attempt to insert any other SIM types.*

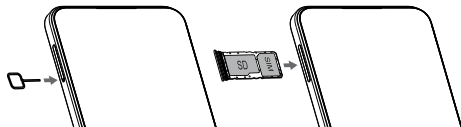

- 1 Insert the SIM pin that's provided to eject the SIM tray and then slide it out gently.
- 2 Place or remove the Nano SIM card and the microSD™ card in the correct slot as shown.

*Note: SIM pin is included in the box. MicroSD™ card is sold separately.*

## Battery

To optimize battery performance, be sure to fully charge your device before using it for the first time.

## Charging the device

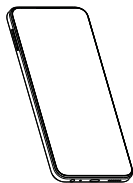

- 1 Insert the USB Type-C cable into the charge port as shown.
- 2 Connect charger to power outlet.



*Note: Please use the charger and USB Type-C cable that came with your device. Using the wrong cable and charger may damage the charging port or reduce battery performance.*

## Security & convenience

To secure your phone from being used by others without your permission, activate the following security options:

### Screen lock:

Swipe up from the home screen, then tap Settings  > Security > Screen lock.

### Fingerprint:

Swipe up from the home screen, then tap Settings  > Security > Fingerprint.

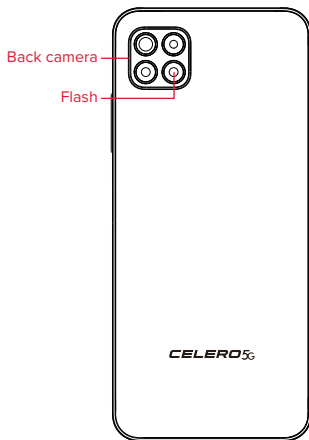

## Approved firmware versions

This device will only operate with firmware versions that have been approved for use by your wireless carrier and the device manufacturer. If unauthorized firmware is placed on the device, it will not function.

## Information about safeguarding handsets

We encourage customers to take appropriate measures to secure their devices and invite them to take advantage of the features available on this device to help secure it from theft and/or other unauthorized access and use. This device has a locking function (e.g., Security PINs) that can serve as a first line of defense against unauthorized use or access to stored information. Preloaded security applications that allow customers to track or locate misplaced devices can be found on several devices. Lost or stolen devices should be immediately reported to your wireless carrier so that proper measures can be taken to protect accounts. For additional information, visit your wireless carrier's Privacy Policy.

## Emergency call

If your phone has network coverage, dial the emergency number and touch  to make an emergency call. This works even without a SIM card and without typing the PIN code.

Although all devices are equipped with 9-1-1 emergency calling, this device may or may not permit its location to be approximated during a 9-1-1 call.\*

\* Availability of this feature depends on upgrades to the (a) wireless network and (b) 9-1-1 calling system that are required to be installed by the local 9-1-1 response agency or public safety answering point (PSAP); these upgrades may not be available everywhere within our wireless coverage area or your roaming area. This approximation of the device's location and the transmittal of location information are subject to emergency situations, transmission limits, network problems/limitations, interconnecting carrier problems, your device, buildings/tunnels, signal strength and atmospheric/topographical conditions, and may be curtailed, interrupted, dropped or refused. The device's approximate location is transmitted to the local 9-1-1 response agency or PSAP while the call is in progress; this approximation is intended solely to aid the PSAP in dispatching emergency assistance or to limit the search area for emergency services personnel. You should not rely solely on a device for essential communications (such as a medical or other emergency). Please see your wireless carrier's Terms and Conditions and Privacy Policy for additional service restrictions and details.

# Additional information

Use of some content or features may require qualifying service or access to a Wi-Fi connection.

5G: Devices may use multi-band dual connectivity to receive and dynamically route traffic between both 4G LTE and 5G signals to support connectivity. The network architecture providing dual connectivity could result in instances where a device indicates a 5G connection when temporarily utilizing only 4G LTE. As 5G technology develops, devices will be able to experience direct and continuous 5G where available.

Devices and screen images are simulated. Coverage not available in some areas. See Terms and Conditions (including arbitration provision) at [dish.com](https://dish.com), for rate plan information, charges for features and services, and restrictions and details.

© Copyright 2021, DISH Wireless L.L.C.  
Celero 5G is a trademark of DISH Wireless L.L.C.